

The background of the entire image is a light blue gradient. It is decorated with several water droplets of various sizes. In the top right corner, there is a large, complex droplet with multiple lobes. Below it, towards the center, are two more droplets: a smaller, round one on the left and a larger, bean-shaped one on the right. In the bottom left corner, there is another large, irregular droplet, and a small, round one just above it. The droplets are highly reflective, showing highlights and shadows that give them a three-dimensional appearance.

MULTIPANEL

**WATERPROOF SMARTER,
NOT HARDER.**



Go with(out) the flow.

Did you know that over 80% of building defects are attributed to moisture-related problems?

As a leader in our space, we use our expert knowledge, innovative service and respectful approach to create better ways to waterproof.

Waterproof smarter, not harder.

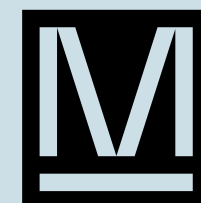

The benchmark of waterproofing excellence.

Easy. Effective. Certified. The only Australian made, Codemark accredited building panels in Australia.

If you're looking for a better way to waterproof, at MULTIPANEL, we're defining new standards in our industry. Simply put, we deliver future-ready waterproofing for a longer-lasting space.

ABOUT MULTIPANEL

MULTIPANEL is an industry leader in the design, manufacturing and installation of innovative waterproofing solutions.

We're an Australian-owned company driven to change the way people think about waterproofing. Our lightweight, eco-friendly building panels are CodeMark certified and designed to make waterproofing any space easy for everyone.

THE PRODUCT

MULTIPANEL is an Australian-made and CodeMark-certified solution across a range of environments. It's manufactured from an innovative high-density polyurethane composite material with a unique closed-cell structure that makes it 100% waterproof.

MULTIPANEL also boasts excellent insulation and acoustic properties and can be easily installed with standard woodworking tools. Its technologically advanced design and intuitive application open up limitless possibilities for use in both interior and exterior projects.

ACCREDITATIONS & AWARDS



CodeMark Australia Certified
Certificate number CM20270



Australian Made and Owned



ACA Product Innovation
of the Year Winner 2019



100% WATERPROOF

NO MEMBRANE REQUIRED

Unlike traditional panels that rely on liquid membranes, MULTIPANEL is immune to water, offering complete waterproofing as a standalone product.

SUPER LIGHTWEIGHT

MULTIPANEL is up to 80% lighter than traditional products. A 30mm MULTIPANEL weighs only 18kg per sheet (6.25kg/m²).

EFFICIENT

Due to their lightweight build and lack of reliance on a liquid membrane, MULTIPANEL systems can be installed up to 75% faster than traditional systems.

ECO FRIENDLY

MULTIPANEL is an eco-friendly and eco-specified material made partially from plant-based oils with zero-added VOC.

Our durable, high-performance panels offer a sustainable alternative to timber-based products. Their lightweight nature also reduces emissions associated with transportation and allows for more efficient installation.

We're committed to sustainable best practices in the manufacturing and installation of our products.

For more information, visit [EcoSpecifier](#).

Indoor Waterproofing Products



Waterproof Shower Base Kits

MULTIPANEL Shower Base Kits include the base with the fall already graded for an easier installation. Within the hour, you'll be ready to tile.

No leaks. No fuss. No redos. It's that simple.

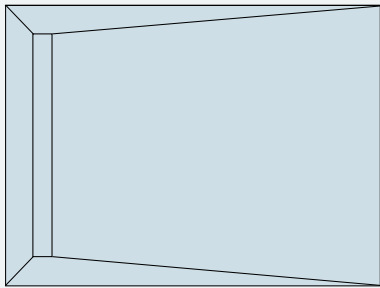
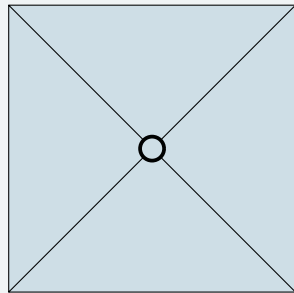

STANDARD SHOWER BASE KIT SIZES
900 x 900mm
1200 x 900mm
1500 x 900mm
1800 x 900mm
Custom sizes available on request, contact us today

LINEAR SHOWER BASE KIT SIZES
900 x 900mm
1200 x 900mm
1500 x 900mm
1800 x 900mm
Larger sizes available upon request, contact us today

For full installation details, please refer to the MULTIPANEL Internal Wet Area Waterproofing System Installation Guide.



Waterproof Niches

With customisable sizes, easy application and 100% waterproof design, MULTIPANEL is the ideal solution for those tricky niches.

- STEP 1: Apply MULTIPANEL Foaming Adhesive to frame as per diagram
- STEP 2: Insert fixing as per diagram
- STEP 3: Apply MULTIPANEL Sealant over penetrations

We manufacture shower niches in the following sizes. All niches come glued and ready to install, for quality waterproofing you can trust.

WATERPROOF NICHE SIZES
320 x 360 x 100mm
420 x 360 x 100mm
624 x 324 x 100mm
824 x 324 x 100mm
Custom sizes available on request, contact us today

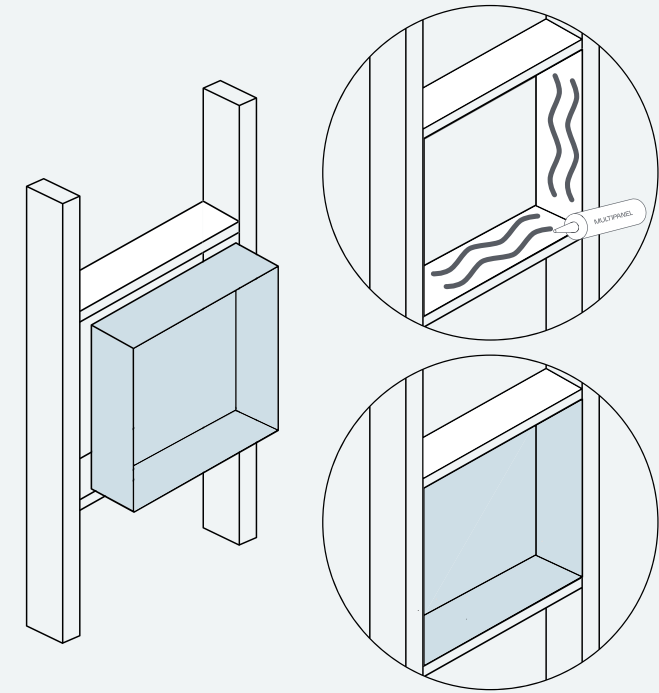

Refer to AS3740 and all relevant waterproofing codes to ensure you meet the requirements.



Waterproof Internal Wet Area System



Waterproofed and ready to tile the following day

Our innovative Internal Waterproofing System is fully certified. It involves 12mm MULTIPANEL used as a waterproof wall in the shower area in conjunction with the base and 8mm MULTIPANEL for waterproofing of internal wet areas.

This efficient system meets the performance requirements of AS3740, eliminating the need for liquid membranes, minimising trades on-site and providing a faster overall build time.

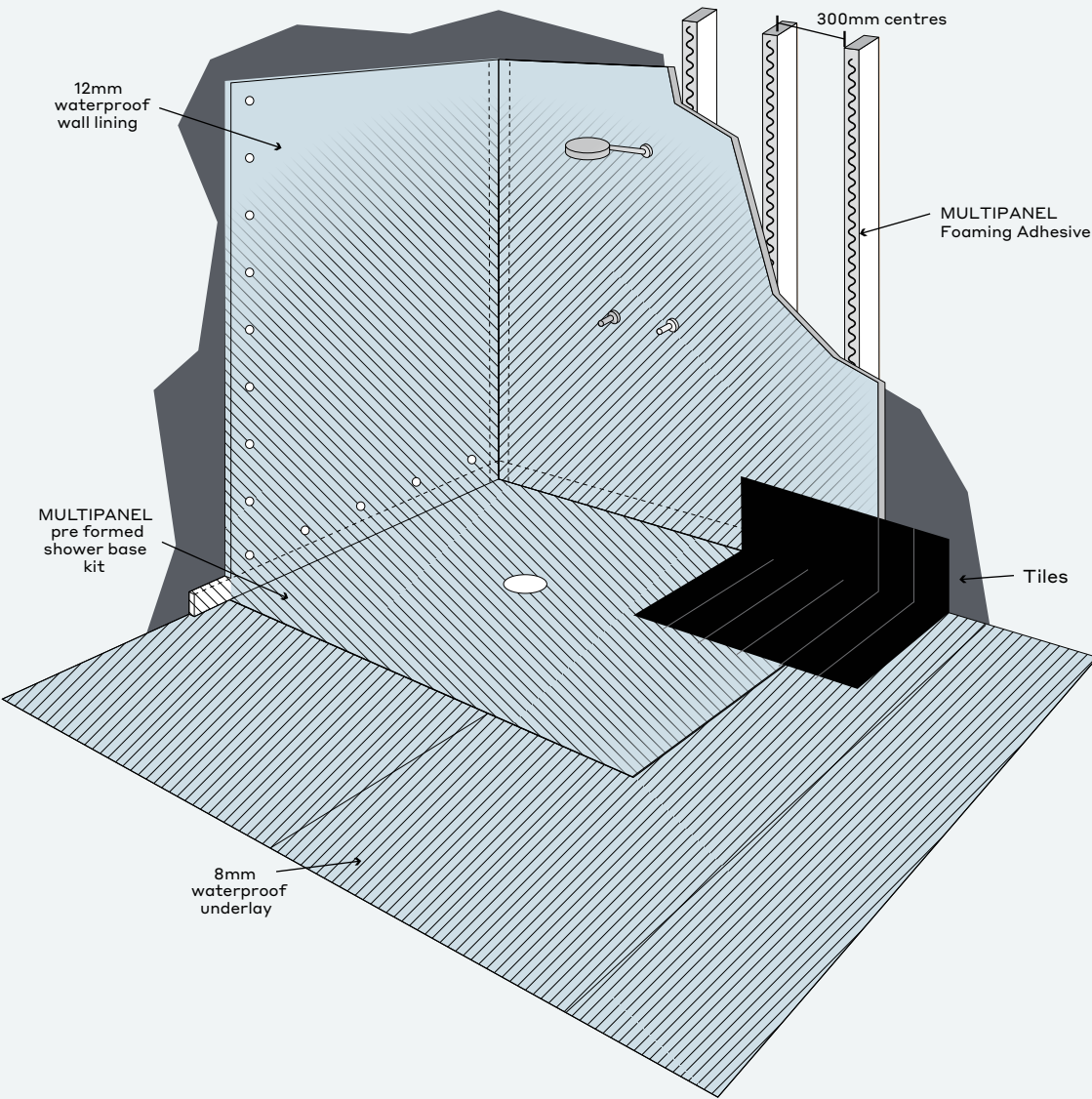

Application	Sheet size	Thickness	Weight	Weight/m ²	“R” value (m2-k/w)
Waterproof Underlay	2400 x 1200mm	8mm	5.2kg	1.8kg/m ²	0.30
Waterproof Wall Lining	2400 x 1200mm	12mm	7.2kg	2.5kg/m ²	0.44

Please refer to the MULTIPANEL internal wet area guide for complete instructions on how to install the waterproof internal wet area system.





Outdoor Waterproofing Products

Waterproof Balcony System

MULTIPANEL'S durability makes it the ideal solution for waterproofing external residential balconies. Each sheet weighs only 18kg, and the edges are tongue and grooved for an intuitive and economical installation process with minimal fuss.

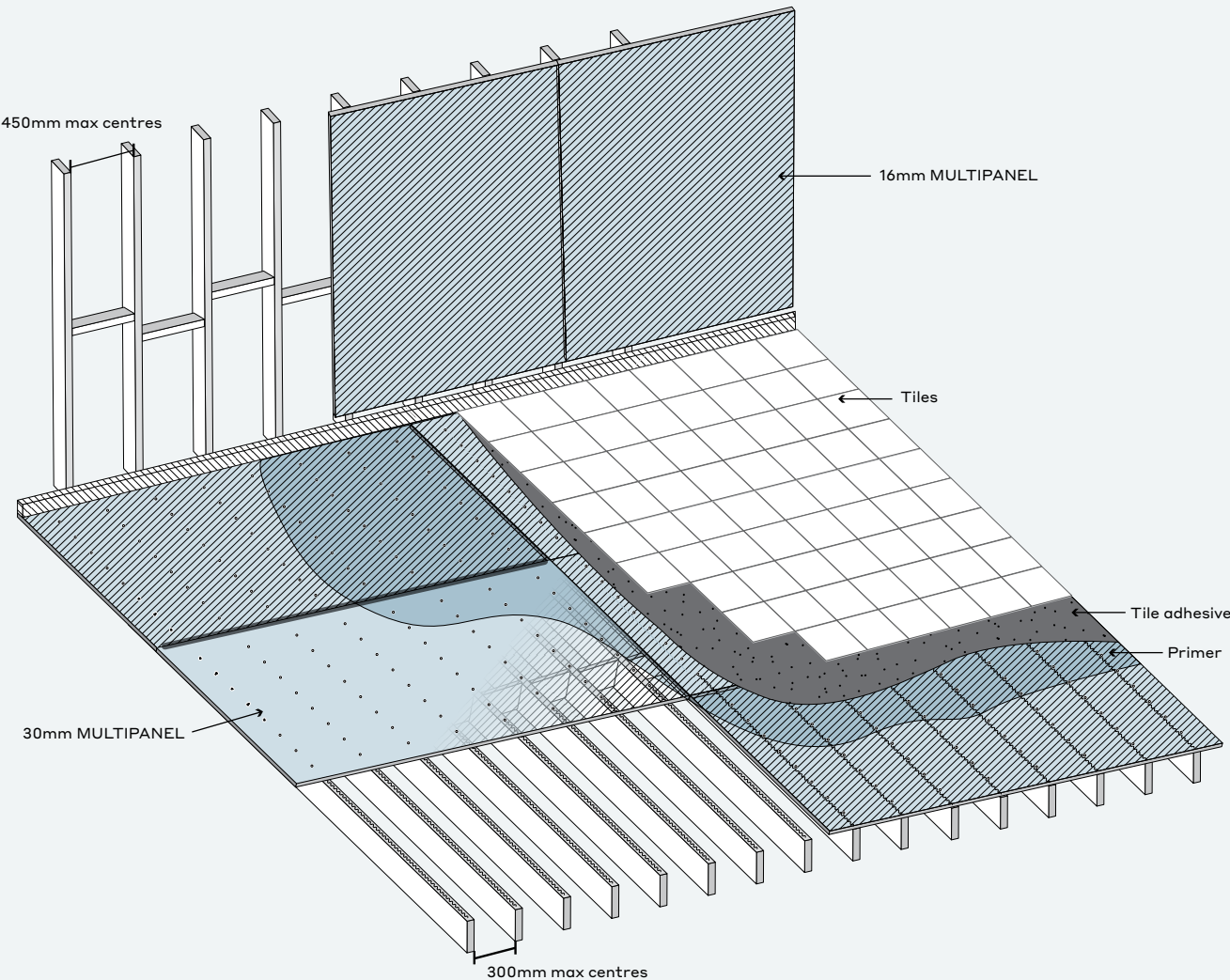

Sheet size	Thickness	Weight	Weight/m ²	“R” value (m2-k/w)
2400 x 1200mm	30mm	18.0kg	6.25kg/m ²	1.11
2400 x 1200mm	16mm	9.2kg	3.19kg/m ²	0.59

All edges of sheets are tongue and grooved for installation convenience and minimising waste. Please refer to the MULTIPANEL Balcony Installation Guide for complete instructions on how to install the waterproof balcony substrate system.



Waterproof Graded Panel System

MULTIPANEL is 100% waterproof, making it a perfect screed replacement for external balconies. A combination of long and short fall graded panels can help you achieve the required fall to waste outlets.

A 10m² balcony using traditional waterproofing would have approximately 1000kg of added weight. Alternatively, using MULTIPANEL would equate to only 150kg of added weight – around 650% lighter.

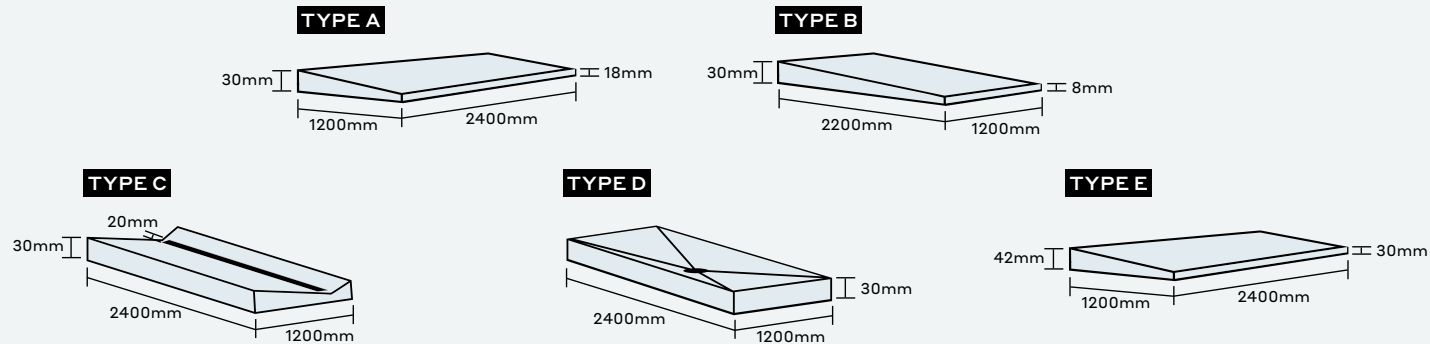

Panel Type	Sheet size	Thickness	Weight	Weight/m ²
Type A	2400 x 1200mm	30mm - 18mm	14.4kg	3.82kg/m ²
Type B	2200 x 1200mm	30mm - 8mm	12.0kg	3.40kg/m ²
Type C	2400 x 1200mm	30mm - 20mm	13.5kg	3.82kg/m ²
Type D	2400 x 1200mm	30mm - 18mm	12.0kg	3.82kg/m ²
Type E	2400 x 1200mm	42mm - 30mm	19.5kg	3.82kg/m ²

For installation and technical specifications, refer to the MULTIPANEL Graded Panel System Installation Guide.



Waterproof Substrate System

Thanks to its durability and 100% waterproof design, MULTIPANEL is an ideal substrate for decking and paver pods that will ensure your system's integrity.

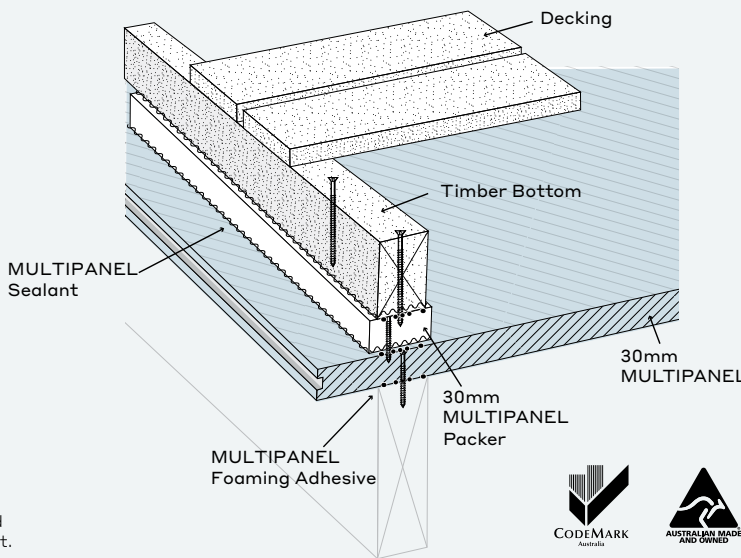

For installation and technical specifications, refer to the third party pod manufacturer and the MULTIPANEL Timber Deck Technical Supplement.



Other Waterproofing Applications

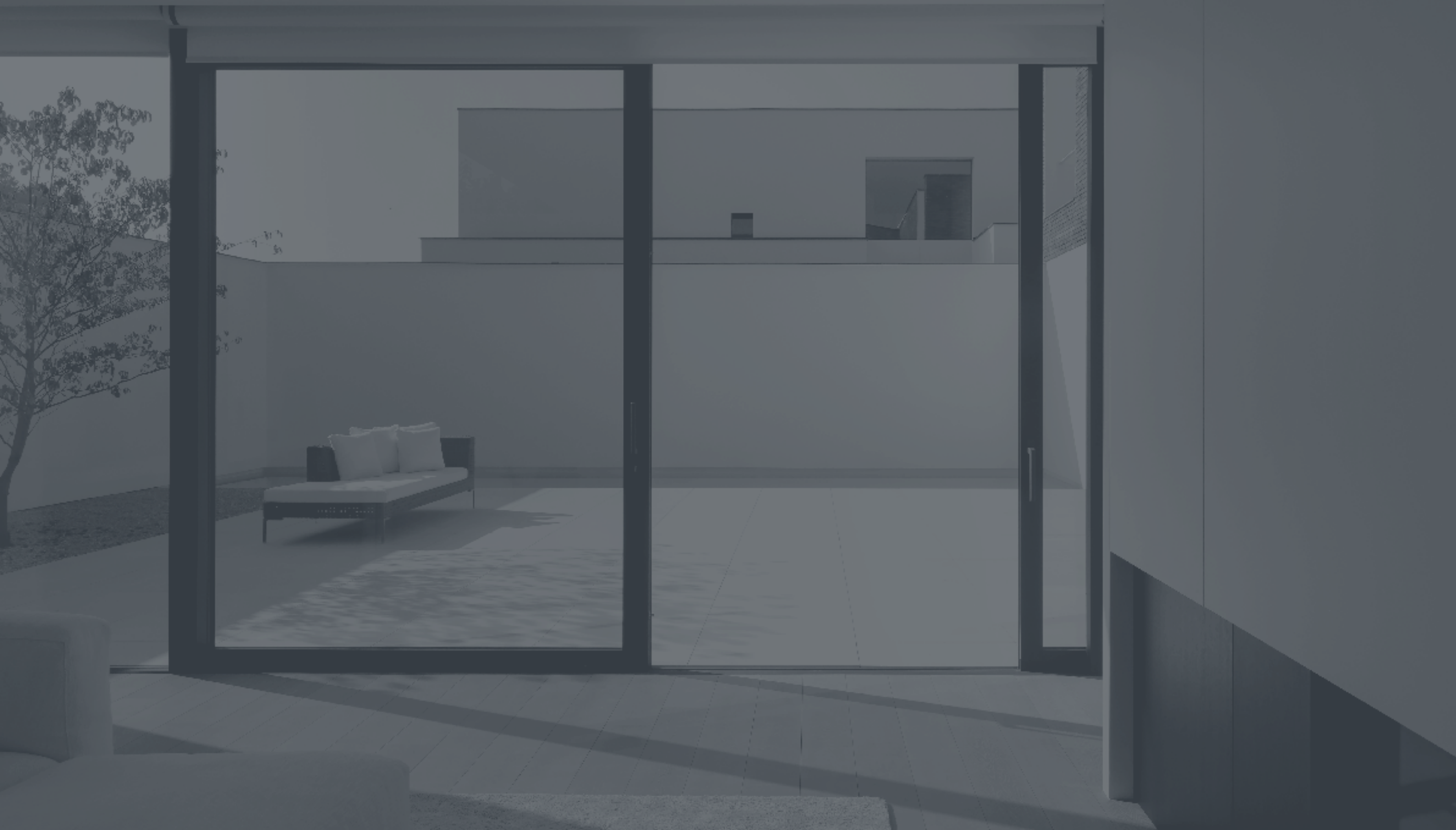

Waterproof Plinth Board

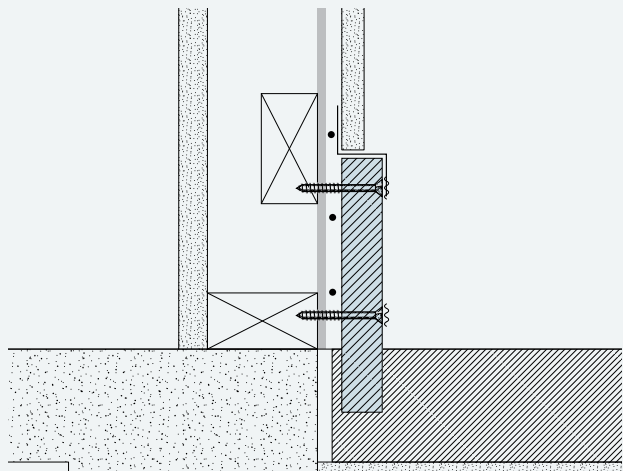

MULTIPANEL'S revolutionary new waterproof plinth board can be easily buried into the ground to create a powerful moisture barrier.

These lightweight boards are simple, cost-effective and 100% waterproof. That means they won't rot, deteriorate or break down over time.

This product can be attached directly to 450mm studs or fixed to an existing solid substrate, making for an easy installation process.

The short edges are tongue and grooved for installation convenience and minimising waste. Please refer to the MULTIPANEL Plinth Technical Supplement guide for complete instructions on how to install the waterproof plinth board.

Plinth size	Thickness	Weight
2400 x 1200 x 295mm	30mm	4.5kg
2400 x 1200 x 200mm	30mm	3.0kg
2400 x 1200 x 170mm	30mm	2.6kg

Waterproof Decorative Panels

MULTIPANEL has developed a 100% waterproof panel designed for decorative facade application and suitable for CNC machining.

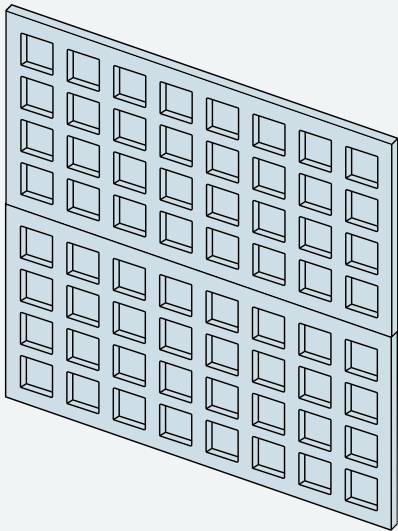

Sheet size	Thickness	Application	Weight/m²
2400 x 1200mm	16mm	Waterproof Facade	5.2kg/m²
2400 x 1200mm	30mm	Waterproof Facade	7.2kg/m²

All edges of sheets are tongue and grooved for installation convenience and minimising waste.

Waterproof Planter Boxes

We've developed specialty panels ideal for lining planter boxes. These 100% waterproof panels are a lightweight and cost-effective way to ensure that any soil movement doesn't affect the waterproof integrity of your box, keeping your plants safe and healthy.

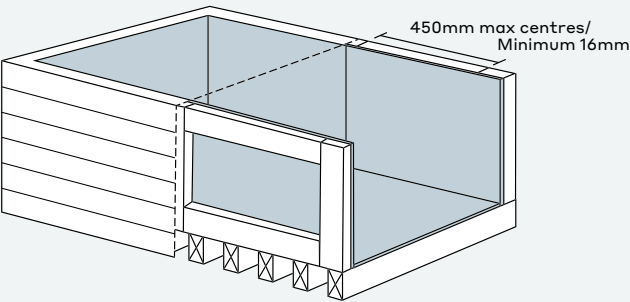
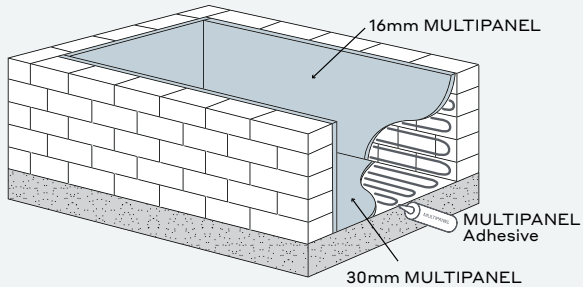

Application	Sheet size	Thickness	Weight	Weight/m²	“R” value (m²-k/w)
30mm Direct to 300mm spacings	2400 x 1200mm	30mm	18.0kg	6.25kg/m²	1.11
16mm To be installed on top of a solid substrate (as per our balcony installation guide)	2400 x 1200mm	16mm	9.2kg	3.19kg/m²	0.59

Waterproof Curved Lining

When traditional materials don't work, MULTIPANEL products will. We've created flexible panels designed to line curved walls, staircases, facades and other tight spaces that can be difficult to waterproof.

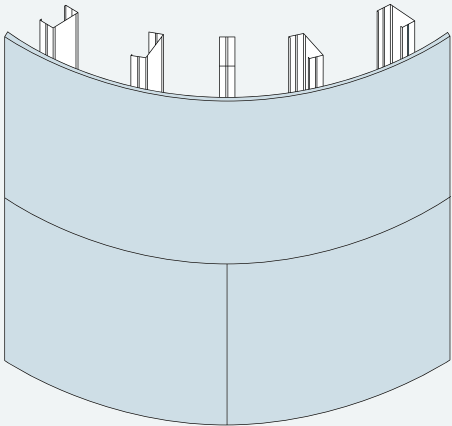

Sheet size	Thickness	Max centres	Application	Approx radius
2400 x 1200mm	8mm	150mm	Curved Lining	400mm
2400 x 1200mm	12mm	200mm	Curved Lining	1000mm
2400 x 1200mm	16mm	300mm	Curved Lining	1500mm
2400 x 1200mm	30mm	400mm	Curved Lining	2500mm

Please ensure the frame is straight and solid as MULTIPANEL will follow the frame.
Note: Frame spacings will depend on the panel thickness and the radius you are trying to achieve.



MULTIPANEL

MULTIPANEL Pty Ltd

Phone +61 3 9787 2544

Email info@multipanel.com.au

multipanel.com.au