

MULTIPANEL Balcony Substrate Waterproofing System

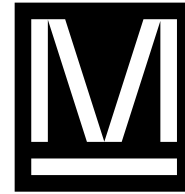

Product Analysis

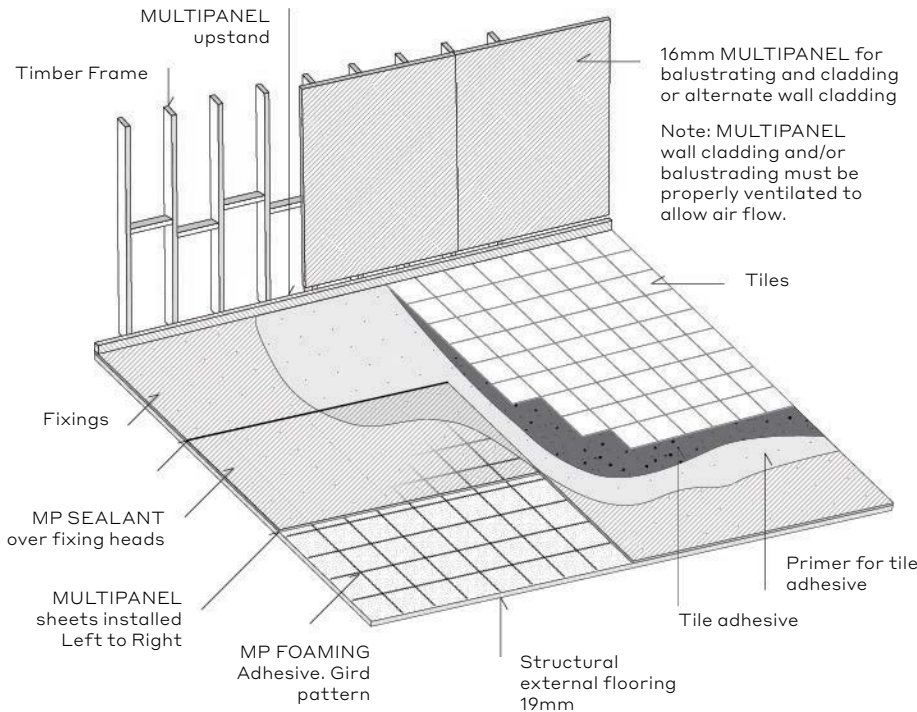

What is MULTIPANEL?

MULTIPANEL manufactures a revolutionary, high-density, polyurethane composite building panel, ideal for waterproofing bathrooms and wet areas as it is lightweight, 100% waterproof, highly versatile and replaces the need for a liquid membrane.

This innovative product is currently the most technologically advanced construction panel on the global market. It is a significantly superior alternate to traditional building materials.

PRODUCT ADVANTAGES

- / Lightweight
- / 100% waterproof
- / Eco-Friendly
- / Labor Saving
- / Insulating

Product	Waterproof	Lightweight	Joist spacing	Ease of construction	Labour installed in 4hrs
15mm Compressed FC 2400 x 1200 x 15mm Approx. 86Kg Per Sheet	NO	NO	450mm	NO Pre-drilling required, very heavy, labour intensive, requires a membrane	8.4 M ² 3 Sheets
19mm Tongue & Groove Cement Sheet 2700 x 600 x 19mm Approx. 40Kg Per Sheet	NO	NO 25Kg M ²	450mm	NO Heavy, requires 2 men to lift, requires a membrane	8.4 M ² 10 Sheets
MULTIPANEL 2400 x 1200 x 30mm 18Kg Per Sheet	YES	YES 6.2Kg M ²	300mm	YES Approx. 76% Lighter NO MEMBRANE REQUIRED	40 M ² 14 Sheets

Independent Product Cost Analysis by the Meccano Group

Product	(\$ Material per M ²)	(\$ Adhesives per M ²)	(\$ Labour per M ²)	(\$ Membrane per M ²)	(\$ Total per M ²)
15mm Compressed FC	55.0	5.0	60.0	40.0	160.0
19mm Tongue & Groove Cement Sheet	60.0	5.0	28.0	40.0	133.0
MULTIPANEL	95.0	5.0	18.0	-	118.0

Cost analysis based on 2 men working 4 hours at \$60 per hour each.
The prices stated above are to be used as a guide only, as there are many factors that can alter the final price.

Product Advantages

Lightweight

A 2400 x 1200mm panel weights only 18kg (6.25Kg M2).

100% Waterproof

No need for any costly membranes over MULTIPANEL as it is totally waterproof.

Eco-Friendly

Independently verified by EcoSpecifier with no VOC emissions.

Labor saving

All edges of the panel are tongue & grooved for installation convenience. MULTIPANEL can be installed up to 75% faster than alternative balcony systems.

Insulating

The 30mm MULTIPANEL has an "R" rating of 1.11 (M2-K/W)

MULTIPANEL

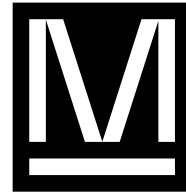

MULTIPANEL Pty Ltd

Phone +61 3 9787 2544
Email info@multipanel.com.au

multipanel.com.au



Certificate CM20270